

TECHNICAL DATA SHEET

SECUNORM 610 XDR WITH HOLSTER NO. 610101

Safety technology

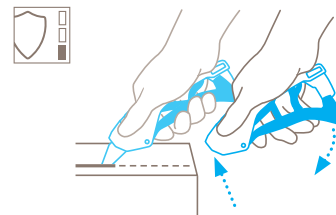

Automatic blade retraction – a high degree of safety

The SECUNORM 610 XDR is equipped with automatic blade retraction: as soon as you release the lever, the blade disappears into the handle – and it stays there too. This provides a high degree of safety from cut injuries.



SET OF DIRT-RESISTANT SAFETY KNIFE AND HOLSTER.

Order No. 610101.09

Bag opener and holster. Two that belong together.

The SECUNORM 610 XDR is the first universal bag opener that cuts efficiently AND safely. Use it to open sacks of any type and thickness, and any content. „XDR“ means eXtra Dirt Resistant. The HOLSTER 610 XDR is the perfect companion to the SECUNORM 610 XDR safety knife – and just like the latter, it is easy to clean and metal detectable. Buy both as a set. This way you have your SECUNORM 610 XDR safely stored and always to hand.

Dirt protection

The SECUNORM 610 XDR's open design has several benefits. Dust and other particles won't stick and moveable parts stay moveable. The lever and blade retraction features then continue to function even under the most difficult conditions.

Long, stainless special blade

The new, extremely sharp LARGE SPECIAL PURPOSE BLADE NO. 160060 has a 32 mm cutting depth. Ideal for quick and

safe cutting of everything from a simple foil bag to multi-layer kraft paper with inliner.

Flexible fastening

Fasten the HOLSTER 610 XDR to your belt or trouser pocket using the clip. Or you can use the optional holder to mount it at your workplace. The holster and knife feature eyelets for secure fastening.

Ergonomic working

The HOLSTER 610 XDR can be worn on the right or left. The knife only requires insertion with the head facing downwards. The holster angle is adjustable to make handling as easy and comfortable as possible.

Metal detectable

When used in sensitive sectors, such as the food industry, disruptions from contamination must be avoided. The plastic of the knife and holster is therefore metal detectable. Both products are also easy to clean.

USAGE

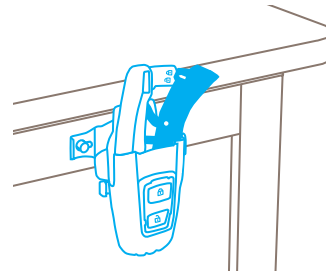
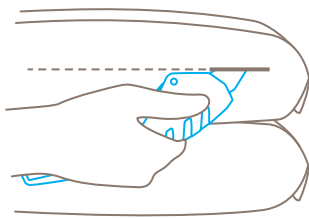

PRODUCT FEATURES

Technical features



High safety



Safer blade change (with magnet)



Very abrasion resistant



Very ergonomic



Safety lock



Cutting depth



Rounded special blade



For right and left handers



Individually engravable



Heavy-duty



Metal detectable



X-ray detectable



Lanyard hole

Main cutting materials



Bagged goods



Cardboard: up to 3-ply



Wrapping, stretch and shrink foil



Plastic strapping band



Foam, polystyrene



Felt



Fleece



Textile, material



Tape



Layers of foil or paper



Coated film



Laminated film



Yarn, cord

Installed blade



NO. 160060
0.63 mm, rounded blade tip, stainless

Optional blade



NO. 160099
0.63 mm, rounded blade tips, deep-edged, stainless



NO. 60099
0.63 mm, rounded blade tips, deep-edged



NO. 60095
0.63 mm, rounded blade tips, deep-edged



NO. 98
0.63 mm

BLADE CHANGE

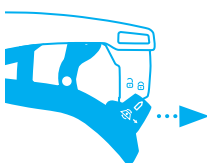

Fully pull out the lock...



...and unfold the handle completely.



Release the spring from the groove by applying **light pressure** and by pressing it to the side. Change the blade and put the replacement **precisely** on the location lobes.

SERVICES OFFERED



Technical data sheet



Consulting service

PRODUCT AND PACKAGING DETAILS

Order No.	NO. 610101.09	Packaging unit	1 set in cardboard-box
Knife size (L x W x H)	163 x 101 x 48 mm	Size Single unit box	165 x 87 x 50 mm
Weight knife	221.0 g	Weight single unit box	262.0 g
Basic material	Aluminium + Metal detectable plastic	EAN Code single unit box	4002632804663
Cutting depth	32 mm	Customs tariff number	82119300

SAFETY CERTIFICATE SECUNORM 610 XDR

Date of issue	06.12.2023
Certification	GS certificate NO. 187356-7897-55094-2023

Certificates and awards SECUNORM 610 XDR



SAFETY ADVICE

To ensure that you use your new MARTOR knife safely and most effectively, please read and note the following user-instructions. Please keep the written guide in a safe place so that you can access it at any time.

1. General application instructions: Please always use the product carefully for manual cutting work only and not for any purposes other than those that are intended. Please take the correct handling and the proper use of the knives into account in this regard. As an additional safety measure, we recommend the wearing of safe gloves.

2. Special application instructions to avoid the danger of injuries: Always take great care when handling the product. Before first use, familiarise yourself with the safety technology and how it works. Before every further use, check the knife for proper functioning. Only use cutting tools that are in perfect condition with sharp, clean and undamaged MARTOR blades. Also make sure that the knife's operation is not impaired by the material to be cut or by dirt or particle deposits around the blade. **CAUTION: The blade is sharp and can result in serious and deep cuts. Therefore, never reach into the blade!** Do not place your free hand in the line of cutting and never cut directly towards you.

3. Replacement of spare parts: Replace any blades that become dull at the right time! Use only the replacement blades from MARTOR for this purpose. Dispose of old blades in a proper fashion. They should not be placed in a waste paper bin, as this poses a considerable danger of injuries. Never perform any repairs yourself. If the knife shows signs of aging or any other wear, e.g. which impair safety features, blade changing or usage, the knife must be taken out of service and replaced. Do not modify this product in any way. Modifications of any kind may impair product safety. **CAUTION: The risk of injury caused by manipulation of this product is extremely high.**

4. Non-use of the knife: Always secure the blade in such a way (depending on product type) that injuries due to cuts are excluded. Store the knife in a secure place.

5. Care instructions: To guarantee a long service life, always keep the knife clean and do not expose it to unnecessary soiling and humidity.

CAUTION: No liability will be assumed for consequential losses. Subject to technical changes and errors! This knife does not belong in the hands of children!

ACCESSORIES

HOLSTER 610 XDR

NO. 9961



The HOLSTER 610 XDR is specially designed for our innovative SECUNORM 610 XDR safety knife. This combination increases user as well as product safety. Whether you wear the holster on your belt or attach it to your workplace, you'll always know where you can safely "park" your knife when you don't need it. You'll then have both hands free to empty the sacks you've just cut open. The robust holster is metal detectable and easy to clean.

HOLSTER 610 XDR BRACKET

NO. 9962



The HOLSTER 610 XDR is specially designed for our innovative SECUNORM 610 XDR safety knife. It is the ideal place to keep your safety knife when you don't need it. You can choose to attach the holster to your belt or mount this practical bracket to your workplace. You can then attach the holster to the holder using the clip. Holster and knife are then always within easy reach.

USED BLADE CONTAINER

NO. 9810



You can fill the USED BLADE CONTAINER with the content of your SAFEBOX. Or directly with your used blades. When the box is full, turn the lid until it shuts. Now the box cannot be reopened. The next step is to safely and completely dispose of the filled USED BLADE CONTAINER as normal waste.

WALL MOUNT BRACKET USED BLADE CONTAINER

NO. 9845

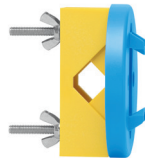

Include it in your order now! With this mounting bracket you can fix your USED BLADE CONTAINER to a central location. Use the clamp and screws and nuts supplied with the product to attach it to either a pipe or a rod.

SAFEBOX

NO. 108000



The SAFEBOX is large enough to store a large number of used blades safely. And at the same time, it is compact enough to carry with you. The two slits are not only used for filling, but also to „shorten“ your snap-off blades. When your SAFEBOX is full, empty it into your USED BLADE CONTAINER.

MDP TEST CARD SET

NO. 9910



There are five cards with different plastic balls in the MDP TEST CARD SET – between 2.5 mm and 8 mm in size. You can reliably test the effectiveness of your metal detectors using the „visiting card“.

MANUFACTURER

MARTOR KG | Lindgesfeld 28 | 42653 Solingen | Germany
T +49 212 73870-0 | info@martor.de | www.martor.com